

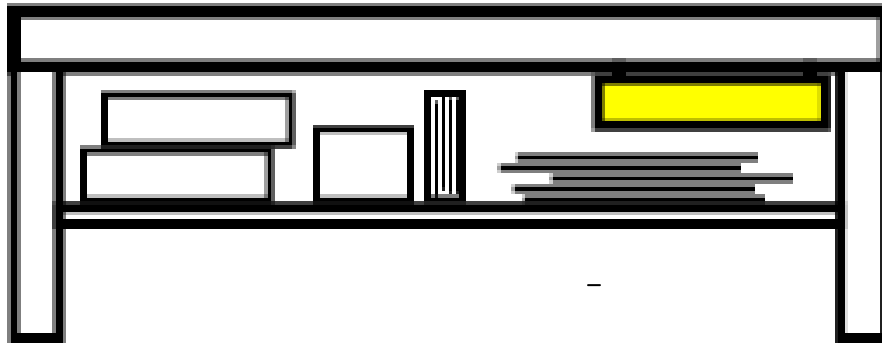

Additional instructions for LACK tables



Underneath of LACK tables



RECOMMENDED NOTICE (this stage is not entirely essential but recommended).

Once you have drilled into the underneath of a LACK table, it is recommended to place small drops of super-glue in the drilled holes, let the glue dry, then screw the screws in.

Any other glue is too weak for this stage and does not harden sufficiently.

Users will notice the screws screw in tighter and the wood raises around the screws. Screw the screws out and file the wood down with a rasp type file.

Users do not have to use very strong super-glue (cheaper super-glue from a Pound shop will suffice). AVOID SKIN CONTACT WITH SUPER-GLUE.

The glue hardens the wood to secure a stronger threading.

Underneath material of LACK tables is fairly soft, using too much force when tightening screws will over-thread a drilled hole, meaning the screw will lose its grip on the SD.

Do not use excessive force, screws can remain 'pinch-tight'.

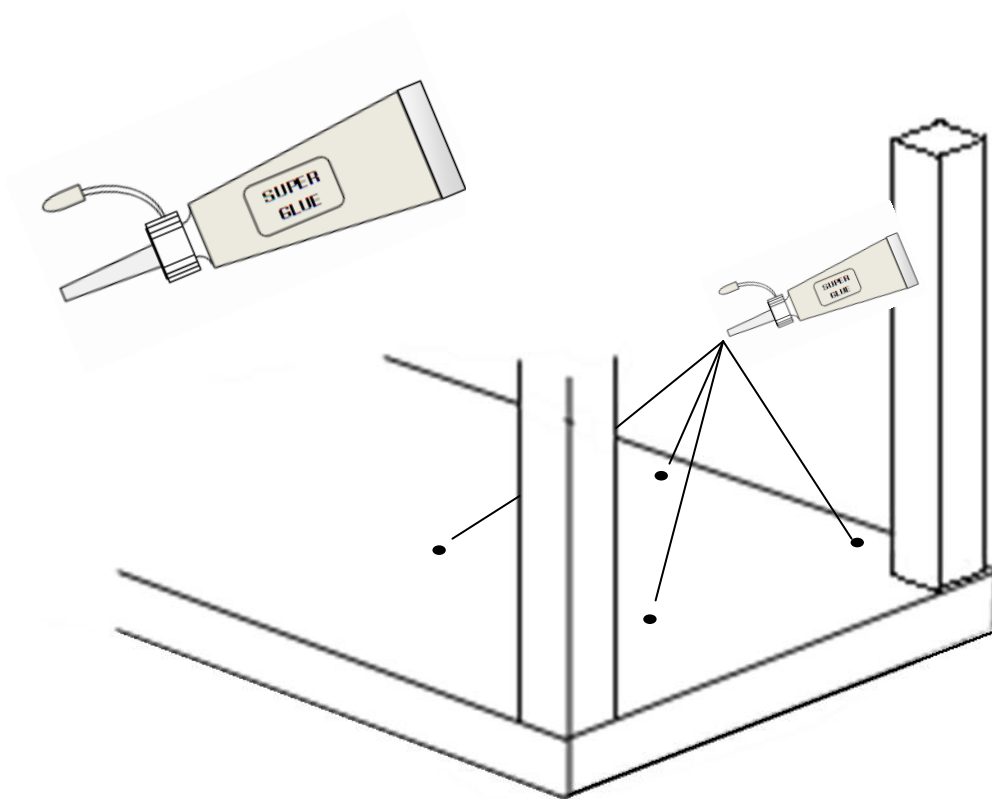

10 min dry

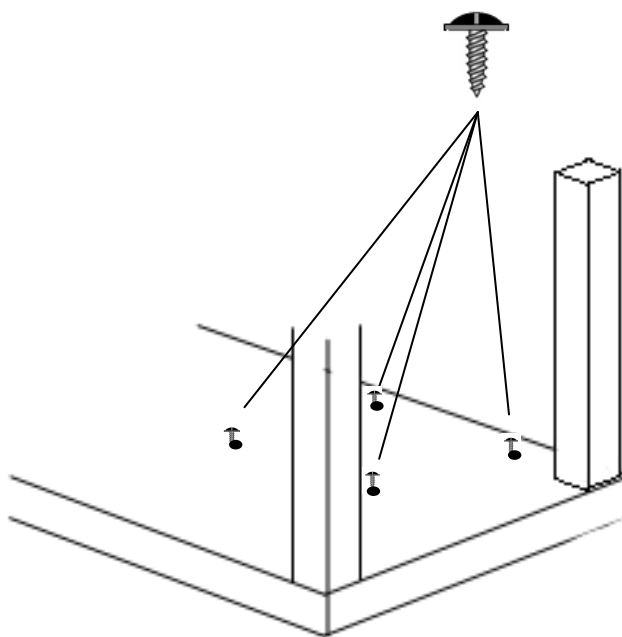

File the raised wood around drilled holes (screw the screws in first then take out screws and file holes).

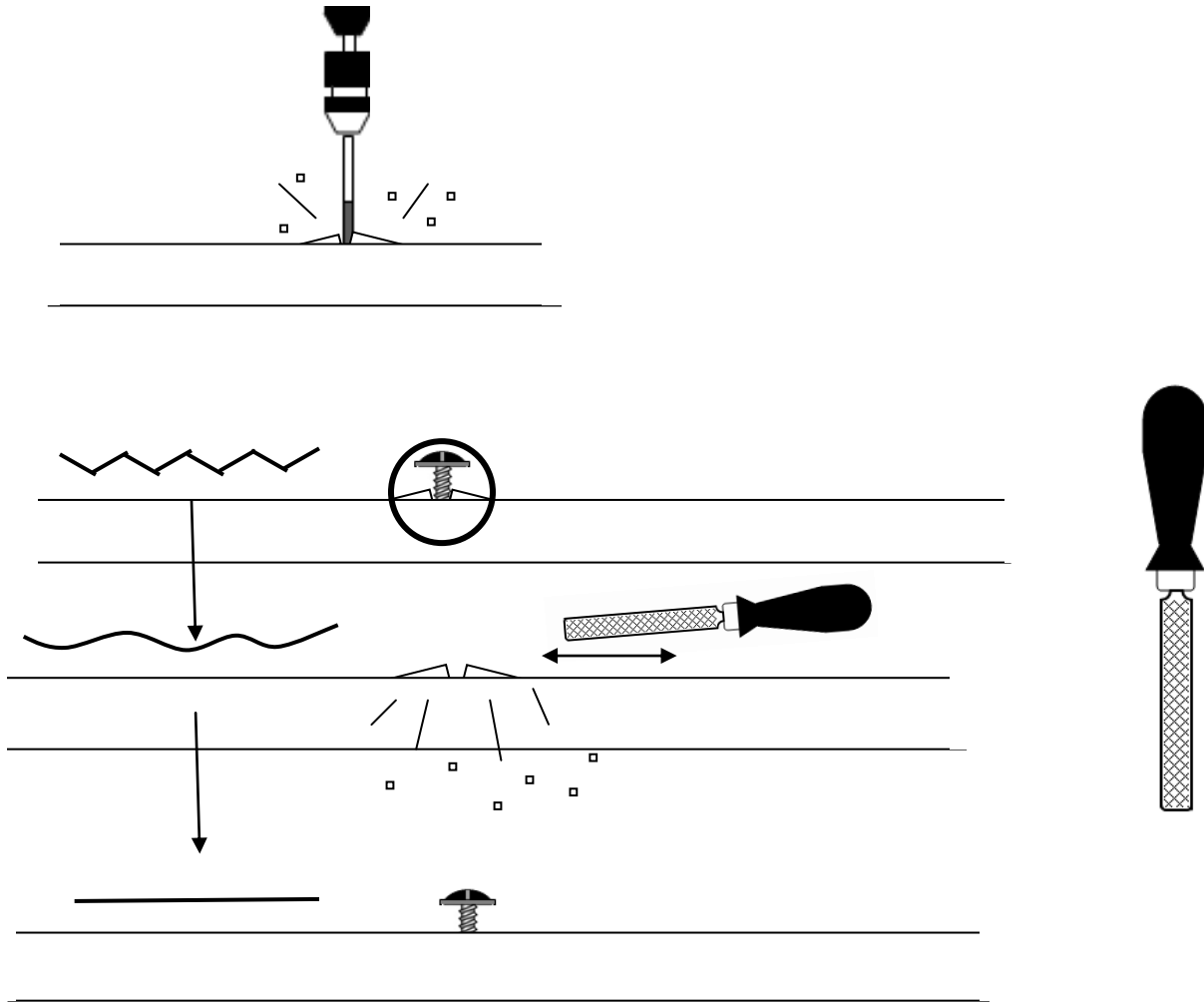

This page is left blank