

H A N D L E W I T H C A R E

SD SPACE DRAWER Mk 5 (beta)

PLASTIC HOOKS

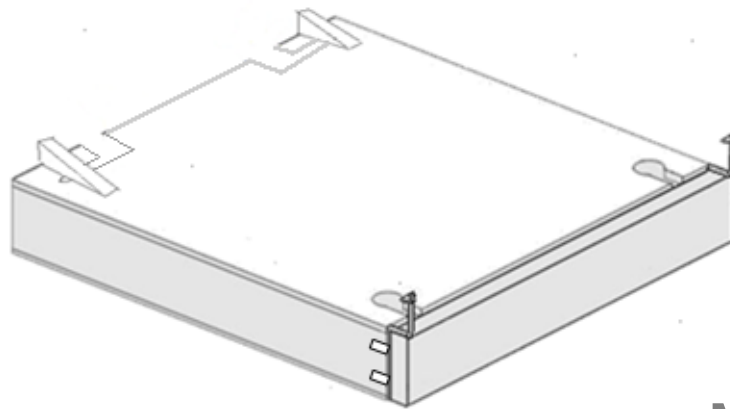

Mk 5

Aesthetics vary

D.I.Y TOOL WORK FREE

1

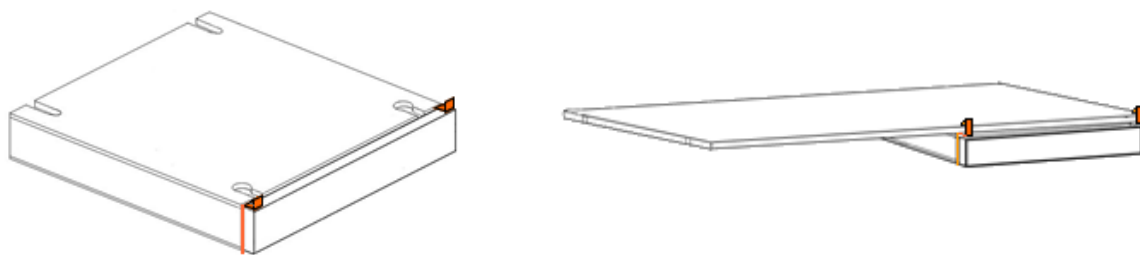

2

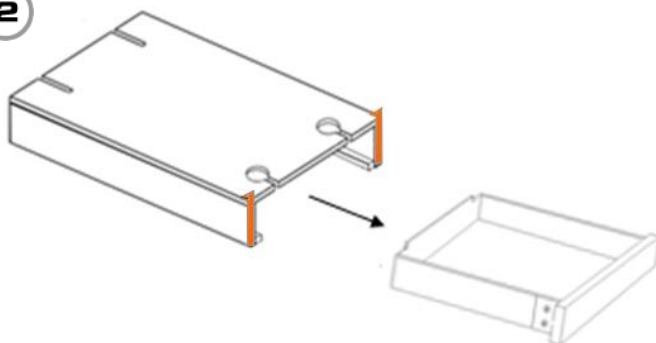

Remove the drawer from the shell.

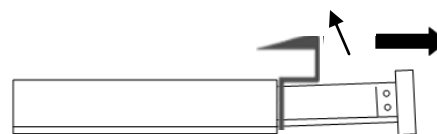

The drawer hits the travel-limiter.

Lift the drawer up and pull out to release and remove.

3

Decide which shelf you will use and remove it.

Removable shelves only

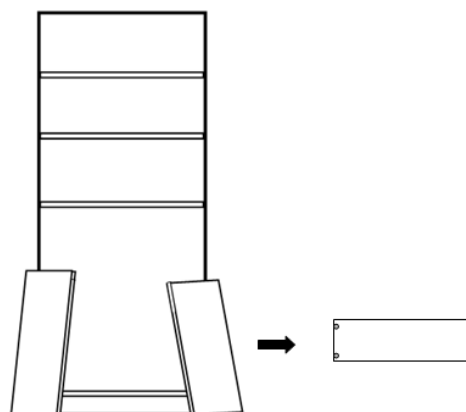

4

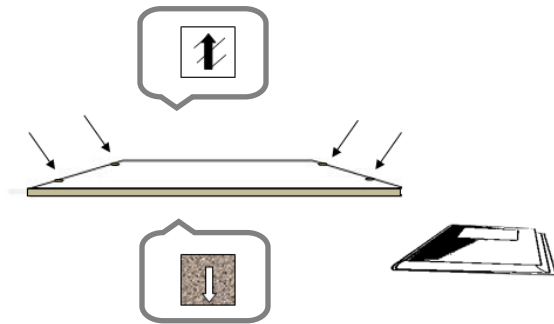

5



PICTURES MAY VARY

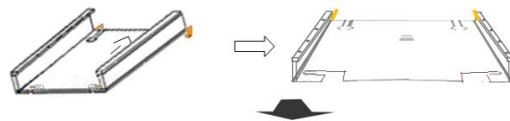

6

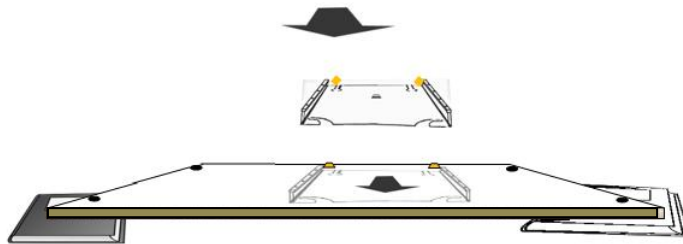

7

HANDLE
WITH
CARE

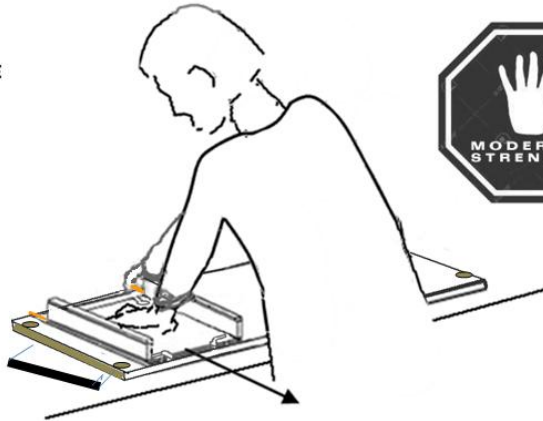

8

If the drawer front hooks fit snugly to a shelf, gently push the hooks and shell back to its limit. DO NOT USE EXTREME FORCE OR BANG HOOKS INTO PLACE TO FIT.

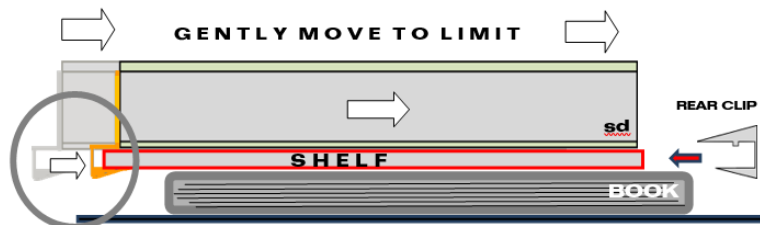

9

